

Who is doing what, where and when

The Ore Valley Forum is a resident-led neighbourhood forum. It works in partnership with agencies and service providers to make the area a better place to live and work.

After consultation with local residents during November, the Forum will revise this draft local plan and send it to the **Hastings Local Strategic Partnership**. This partnership includes all the main service providers and agencies which operate in Hastings & St Leonards.

Once approved by the Local Strategic Partnership, the plan will be supported and put into action.



Further information

Ore Valley Forum
Joy Collins, Coordinator
The Community Flat, 140 Priory Road, Hastings
Tel: 01424 202329
Email: joy.surestart@virgin.net

Amicus/1066 Housing Association
45-51 Chiltern Drive, Broomgrove
open 9.30 to 4
Tel 01424 781291

Hastings Information Centre
Queens Square, Priory Meadow, Hastings,
East Sussex TN34 1TL
Tel: 01424 781111
Email: hic_info@hastings.gov.uk
www.hastings.gov.uk

The Regeneration Centre
45a Robertson Street, Hastings TN34 1HL
Tel: 01424 429438 Fax: 01424 445992
Email: contactus@ourfuture.org.uk
www.ourfuture.org.uk
Open 11 to 4 Tues to Sat

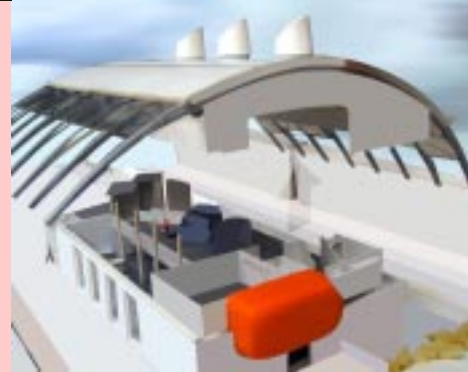

Public consultation material produced under contract by Clive Jacotine & Associates Limited with Nick Wates Associates
Graphic Design: Intergrafix

ORE VALLEY LOCAL ACTION PLAN



Produced by the Ore Valley Forum

This is our draft Local Action Plan for Ore Valley.

After consultation with local residents and with the service providers it will be revised and finalised. It will then become part of the overall Community Strategy for Hastings & St Leonards.

The Action Plan sets priorities for action over the next 12 to 18 months based on key issues identified by the community.

Several important and exciting developments are planned for the area and these will also be progressed during this period:

- 1 The Hastings Millennium Community project which will include 400 new homes, community facilities and better rail links.
- 2 Plans by 1066 Housing Association to demolish some poor quality homes and convert some flats into houses in Broomgrove and Farley Bank, and to carry out a big facelift on the Halton estate.
- 3 A new community centre in Broomgrove.
- 4 Remodelling of the Priory neighbourhood Centre as a multi-purpose community centre.

your views wanted

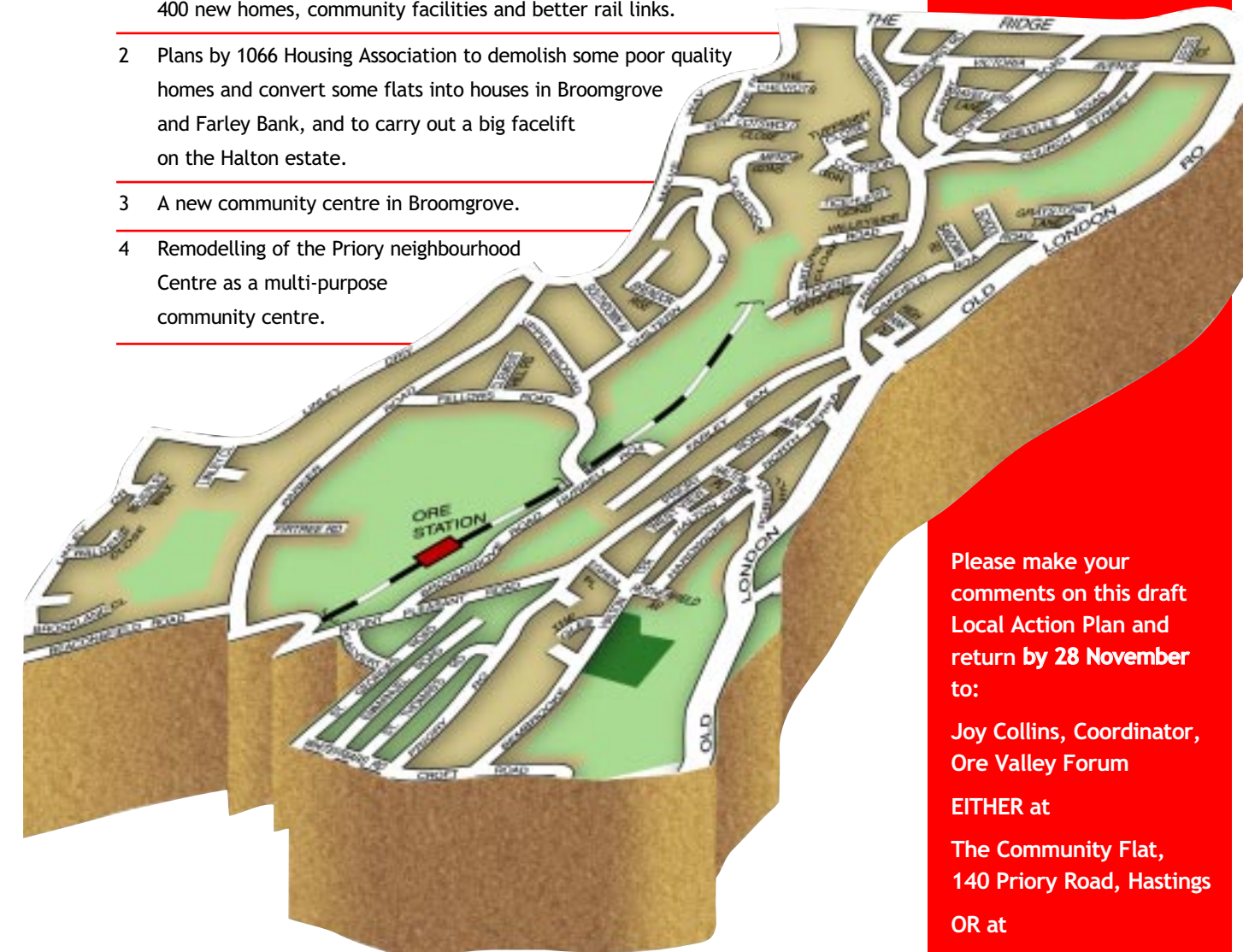

Please make your comments on this draft Local Action Plan and return by 28 November to:

Joy Collins, Coordinator,
Ore Valley Forum

EITHER at

The Community Flat,
140 Priory Road, Hastings

OR at

Surestart, 46-48 Chiltern
Drive, Hastings

Please Complete

Complete your details below (optional) and return by 28 November to:
Joy Collins, Ore Valley Forum EITHER at The Community Flat, 140 Priory Road, Hastings
OR at Surestart, 46-48 Chiltern Drive, Broomgrove, Hastings.

Name		
Address		
Telephone:	E-Mail:	Ethnic Origin:
Age Group	under 13 <input type="checkbox"/>	13 to 18 <input type="checkbox"/>
	19 to 29 <input type="checkbox"/>	30 to 39 <input type="checkbox"/>
	40 to 49 <input type="checkbox"/>	50 to 59 <input type="checkbox"/>
	60 to 69 <input type="checkbox"/>	over 69 <input type="checkbox"/>
I would like to help by		
General comments or suggestions		

November 2002

Key Issues

Comment on the Forum's ideas so far and add yours in the spaces provided.

1 CRIME

- | | Agree | Disagree | No opinion |
|--|--------------------------|--------------------------|--------------------------|
| A Fear of crime, especially for elderly. | <input type="checkbox"/> | <input type="checkbox"/> | <input type="checkbox"/> |
| B Anti-social behaviour. | <input type="checkbox"/> | <input type="checkbox"/> | <input type="checkbox"/> |
| C Vandalism and dumping cars. | <input type="checkbox"/> | <input type="checkbox"/> | <input type="checkbox"/> |
| D Drugs. | <input type="checkbox"/> | <input type="checkbox"/> | <input type="checkbox"/> |
| E Lack of police presence. | <input type="checkbox"/> | <input type="checkbox"/> | <input type="checkbox"/> |

Other key crime issues and comments

.....

.....

.....

2 HOUSING

- | | | | |
|--|--------------------------|--------------------------|--------------------------|
| A The redevelopment and refurbishment plans of 1066 Housing Association and others and how residents will be affected. | <input type="checkbox"/> | <input type="checkbox"/> | <input type="checkbox"/> |
| B Housing Association and Council lettings policy creating an unbalanced community with too many 'problem families'. | <input type="checkbox"/> | <input type="checkbox"/> | <input type="checkbox"/> |
| C Anti-social behaviour not dealt with. | <input type="checkbox"/> | <input type="checkbox"/> | <input type="checkbox"/> |
| D Vandalism to key worker housing. | <input type="checkbox"/> | <input type="checkbox"/> | <input type="checkbox"/> |
| E Unattractive entrances to blocks of flats and maisonettes. | <input type="checkbox"/> | <input type="checkbox"/> | <input type="checkbox"/> |

Other key housing issues/comments

.....

.....

.....

3 ENVIRONMENT

- | | | | |
|--|--------------------------|--------------------------|--------------------------|
| A Maintenance of open space and flytipping. | <input type="checkbox"/> | <input type="checkbox"/> | <input type="checkbox"/> |
| B Overgrown and badly maintained pathways, which are also poorly lit. | <input type="checkbox"/> | <input type="checkbox"/> | <input type="checkbox"/> |
| C How the long term plans for redeveloping the area will affect residents. | <input type="checkbox"/> | <input type="checkbox"/> | <input type="checkbox"/> |
| D Lack of open space suitable for play. | <input type="checkbox"/> | <input type="checkbox"/> | <input type="checkbox"/> |
| E Poor local shopping and the state of Malvern Way shops. | <input type="checkbox"/> | <input type="checkbox"/> | <input type="checkbox"/> |
| F Dog nuisance. | <input type="checkbox"/> | <input type="checkbox"/> | <input type="checkbox"/> |
| G Conserving the Valley's natural habitat and wildlife. | <input type="checkbox"/> | <input type="checkbox"/> | <input type="checkbox"/> |

Other environment issues/ comments

.....

.....

.....

4 EDUCATION & YOUNG PEOPLE

- | | | | |
|--|--------------------------|--------------------------|--------------------------|
| A Youth service not taking a lead. | <input type="checkbox"/> | <input type="checkbox"/> | <input type="checkbox"/> |
| B Difficult to get young children into school. | <input type="checkbox"/> | <input type="checkbox"/> | <input type="checkbox"/> |
| C Lack of local homework clubs. | <input type="checkbox"/> | <input type="checkbox"/> | <input type="checkbox"/> |

- | | Agree | Disagree | No opinion |
|--|--------------------------|--------------------------|--------------------------|
| D Not enough things for children and young people to do. | <input type="checkbox"/> | <input type="checkbox"/> | <input type="checkbox"/> |

Other key education issues/ comments

.....

.....

.....

5 COMMUNITY FACILITIES

- | | | | |
|---|--------------------------|--------------------------|--------------------------|
| A Concern over affordable access to the new community facilities. | <input type="checkbox"/> | <input type="checkbox"/> | <input type="checkbox"/> |
| B Not enough residents taking an active part in their community. | <input type="checkbox"/> | <input type="checkbox"/> | <input type="checkbox"/> |

Other facility issues/ comments

.....

.....

.....

6 HEALTH

- | | | | |
|--|--------------------------|--------------------------|--------------------------|
| A 13.3% of the working age population suffer from a limiting long-term illness. | <input type="checkbox"/> | <input type="checkbox"/> | <input type="checkbox"/> |
| B The area has a high level of early deaths. | <input type="checkbox"/> | <input type="checkbox"/> | <input type="checkbox"/> |
| C No GP or dentist in area, and the loss of a community health worker. | <input type="checkbox"/> | <input type="checkbox"/> | <input type="checkbox"/> |
| D High levels of mental health problems: depression, unemployment, and depression. | <input type="checkbox"/> | <input type="checkbox"/> | <input type="checkbox"/> |
| E Lack of a local health centre. | <input type="checkbox"/> | <input type="checkbox"/> | <input type="checkbox"/> |

Other key health issues/ comments

.....

.....

.....

7 TRANSPORT

- | | | | |
|---|--------------------------|--------------------------|--------------------------|
| A No buses after 7pm so area very cut off with people depending on expensive taxis. | <input type="checkbox"/> | <input type="checkbox"/> | <input type="checkbox"/> |
| B Poor access across the valley, with estates cut off from each other. | <input type="checkbox"/> | <input type="checkbox"/> | <input type="checkbox"/> |

Other key transport issues/ comments

.....

.....

.....

8 POVERTY AND WORKLESSNESS

- | | | | |
|---|--------------------------|--------------------------|--------------------------|
| A Broomgrove is within the worst 10% of areas nationally for child poverty. | <input type="checkbox"/> | <input type="checkbox"/> | <input type="checkbox"/> |
|---|--------------------------|--------------------------|--------------------------|

Other key poverty issues/ comments

.....

.....

.....

Priorities for Action in the next 12 - 18 months

Comment on the Forum's ideas so far and add yours in the spaces provided.

1 SAFER PLACE

- | | Agree | Disagree | No opinion |
|---|--------------------------|--------------------------|--------------------------|
| A Improve lighting and make the pathways safer. | <input type="checkbox"/> | <input type="checkbox"/> | <input type="checkbox"/> |
| B 1066, the police and the Council to jointly tackle anti-social behaviour. | <input type="checkbox"/> | <input type="checkbox"/> | <input type="checkbox"/> |

Other priorities/comments

.....

.....

.....

2 DECENT HOMES

- | | | | |
|---|--------------------------|--------------------------|--------------------------|
| A Agree a local lettings policy to support a balanced community. | <input type="checkbox"/> | <input type="checkbox"/> | <input type="checkbox"/> |
| B Agree local housing management standards and give residents a direct say in how housing services are delivered and monitored. | <input type="checkbox"/> | <input type="checkbox"/> | <input type="checkbox"/> |
| C Agree with residents local development standards for new and improved housing with residents. | <input type="checkbox"/> | <input type="checkbox"/> | <input type="checkbox"/> |

Other priorities/comments

.....

.....

.....

3 A GOOD PLACE TO LIVE

- | | | | |
|--|--------------------------|--------------------------|--------------------------|
| A Tackle flytipping and prosecute offenders. | <input type="checkbox"/> | <input type="checkbox"/> | <input type="checkbox"/> |
| B Promote responsible dog ownership. | <input type="checkbox"/> | <input type="checkbox"/> | <input type="checkbox"/> |
| C Hold a major community planning event in 2003 so the community can be involved in designing changes to the whole area. | <input type="checkbox"/> | <input type="checkbox"/> | <input type="checkbox"/> |
| D Produce a map of land ownership in the Valley. | <input type="checkbox"/> | <input type="checkbox"/> | <input type="checkbox"/> |
| E Undertake an audit of wildlife and plants. | <input type="checkbox"/> | <input type="checkbox"/> | <input type="checkbox"/> |

Other priorities/comments

.....

.....

.....

4 CHILDREN AND YOUNG PEOPLE

- | | | | |
|--|--------------------------|--------------------------|--------------------------|
| A Education Action Zone to fund at least one local education initiative in the community and to support volunteer involvement. | <input type="checkbox"/> | <input type="checkbox"/> | <input type="checkbox"/> |
| B A mobile play centre for 5-13 year olds until the new community centres are ready. | <input type="checkbox"/> | <input type="checkbox"/> | <input type="checkbox"/> |
| C A joint plan for youth provision in the Valley, with a calendar of all youth-related events for next year. | <input type="checkbox"/> | <input type="checkbox"/> | <input type="checkbox"/> |

- | | Agree | Disagree | No opinion |
|--|--------------------------|--------------------------|--------------------------|
| D Drop-in advice centre locally for young people (like Xtrax). | <input type="checkbox"/> | <input type="checkbox"/> | <input type="checkbox"/> |

Other priorities/comments

.....

.....

.....

5 COMMUNITY SUPPORT

- | | | | |
|---|--------------------------|--------------------------|--------------------------|
| A Recruit more residents to take an active part in their community, and give them training and support. | <input type="checkbox"/> | <input type="checkbox"/> | <input type="checkbox"/> |
| B New joint working group of agencies and residents to co-ordinate support to the community throughout the Valley. | <input type="checkbox"/> | <input type="checkbox"/> | <input type="checkbox"/> |
| C Produce a business plan by June 2003 to show how both new community centres can provide affordable access for local people. | <input type="checkbox"/> | <input type="checkbox"/> | <input type="checkbox"/> |

Other priorities/comments

.....

.....

.....

6 A HEALTHIER PLACE

- | | | | |
|--|--------------------------|--------------------------|--------------------------|
| A The Primary Care Trust to train residents to carry out a health survey and to look at providing a new health centre. | <input type="checkbox"/> | <input type="checkbox"/> | <input type="checkbox"/> |
| B Research with the Primary Care Trust the cause of early deaths in the area. | <input type="checkbox"/> | <input type="checkbox"/> | <input type="checkbox"/> |

Other priorities/comments

.....

.....

.....

7 TRANSPORT

- | | | | |
|---|--------------------------|--------------------------|--------------------------|
| A Survey of local transport needs to explore the case for better buses. | <input type="checkbox"/> | <input type="checkbox"/> | <input type="checkbox"/> |
| B Traffic management and road survey to explore effectiveness of traffic calming. | <input type="checkbox"/> | <input type="checkbox"/> | <input type="checkbox"/> |

Other priorities/comments

.....

.....

.....

8 ECONOMIC SUCCESS

- | | | | |
|--|--------------------------|--------------------------|--------------------------|
| A Identify potential local employers and related training opportunities. | <input type="checkbox"/> | <input type="checkbox"/> | <input type="checkbox"/> |
|--|--------------------------|--------------------------|--------------------------|

Other priorities/comments

.....

.....

.....