

White Rock Gardens

DRAFT MASTERPLAN

Your views wanted

Improving White Rock Gardens

White Rock Gardens is the second largest park in Hastings and St Leonards and will be celebrating its centenary in 2004. Now there is an opportunity to improve this important area.

Hastings Borough Council has allocated £200,000 to improve the west side of the Gardens. In addition money has been set aside to replace the indoor bowling centre. With a new University planned for central Hastings, there may be other possibilities for attracting funding with the right ideas.

The Council is therefore preparing a Masterplan for the Gardens to ensure that the most is made of the opportunities and is keen to ensure that this reflects local views.

Building on success

The draft proposals in this document are based on feedback from over 200 people who attended two Community Design Days in February and 116 who submitted suggestions in writing or drawings.

Eight main objectives have been identified from this first round of public consultation, and over 50 detailed proposals for achieving them. These range from fairly simple improvements which could be implemented quite soon, to more visionary ideas which will need further investigation and fund raising.

The overall strategy is to build on and develop the many successful things already happening, at the same time as exploring a range of new initiatives designed to realise the tremendous potential of the area during the Gardens' second century.

What happens next?

Have we got it right? Is this what people want? Please:

- Read through this Draft Masterplan;
- Have another look round the Gardens and imagine what it might be like;
- Make your views known before the end of July.

The Masterplan will then be revised and considered formally by the Council as a basis for future action.



People taking part in the Community Design Days at White Rock Theatre on 22 & 23 February.

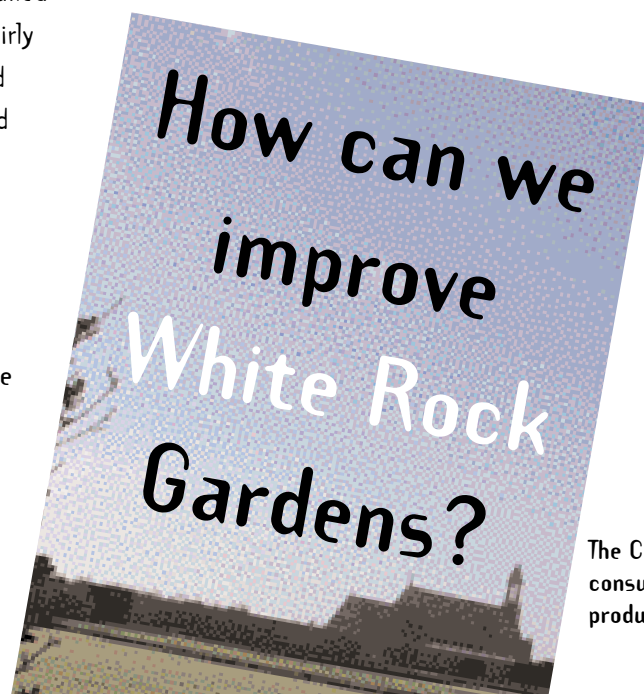

The Council's first consultation leaflet produced in February.

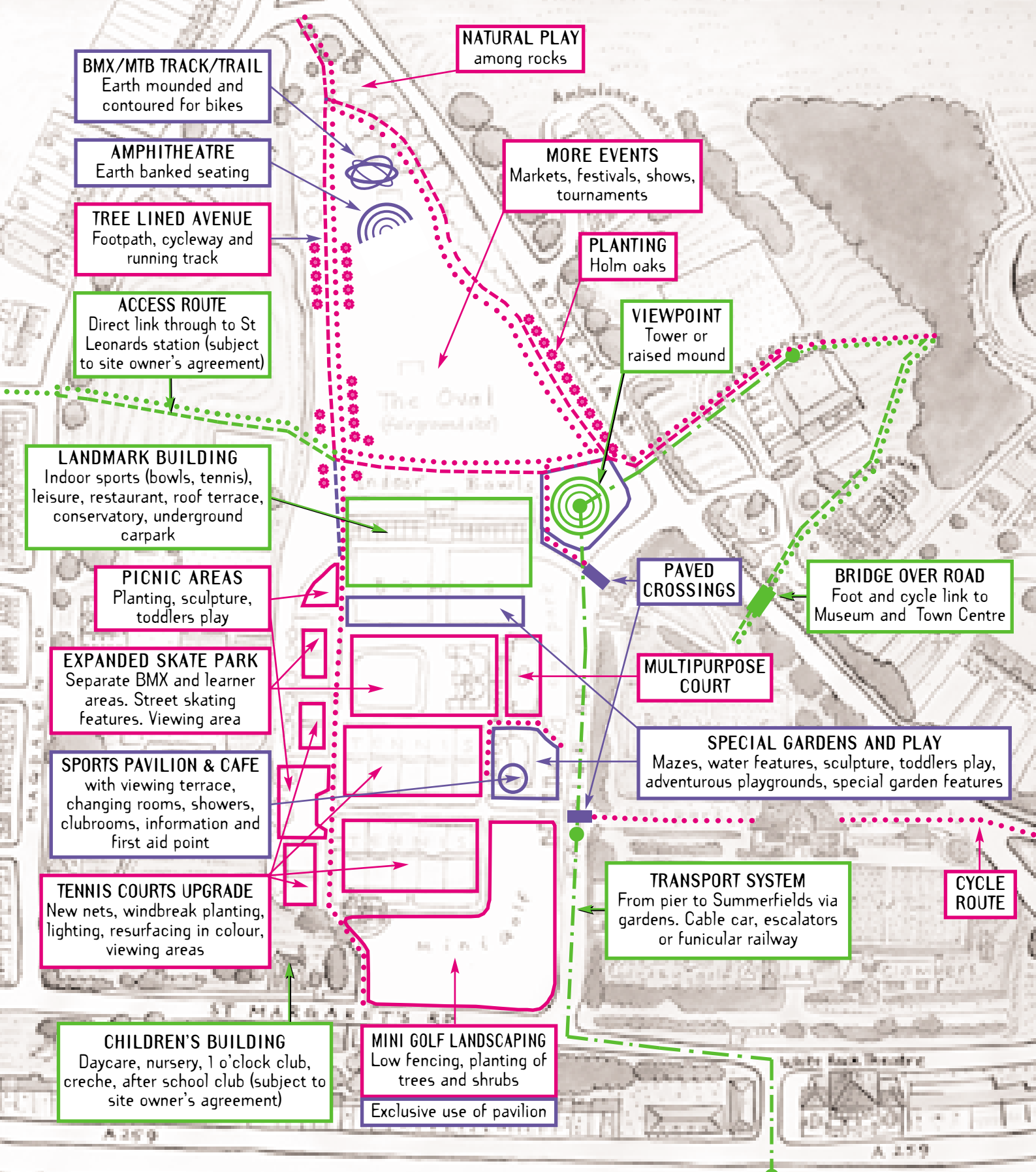

BMX/MTB TRACK/TRAIL
Earth mounded and contoured for bikes

AMPHITHEATRE
Earth banked seating

TREE LINED AVENUE
Footpath, cycleway and running track

ACCESS ROUTE
Direct link through to St Leonards station (subject to site owner's agreement)

LANDMARK BUILDING
Indoor sports (bowls, tennis), leisure, restaurant, roof terrace, conservatory, underground carpark

PICNIC AREAS
Planting, sculpture, toddlers play

EXPANDED SKATE PARK
Separate BMX and learner areas. Street skating features. Viewing area

SPORTS PAVILION & CAFE
with viewing terrace, changing rooms, showers, clubrooms, information and first aid point

TENNIS COURTS UPGRADE
New nets, windbreak planting, lighting, resurfacing in colour, viewing areas

CHILDREN'S BUILDING
Daycare, nursery, 1 o'clock club, creche, after school club (subject to site owner's agreement)

MINI GOLF LANDSCAPING
Low fencing, planting of trees and shrubs
Exclusive use of pavilion

NATURAL PLAY
among rocks

MORE EVENTS
Markets, festivals, shows, tournaments

PLANTING
Holm oaks

VIEWPOINT
Tower or raised mound

PAVED CROSSINGS

BRIDGE OVER ROAD
Foot and cycle link to Museum and Town Centre

MULTIPURPOSE COURT

SPECIAL GARDENS AND PLAY
Mazes, water features, sculpture, toddlers play, adventurous playgrounds, special garden features

TRANSPORT SYSTEM
From pier to Summerfields via gardens. Cable car, escalators or funicular railway

CYCLE ROUTE

White Rock Gardens Draft Masterplan

MAIN NEW FEATURES

Short term 2003 - 2005 **—** Medium term 2006 - 2010 **—** Long term 2011 - **—**

Objectives and proposals (please tick boxes and add suggestions)

agree
disagree
no opinion

1. Range of attractions for all

A greater range of diverse, mutually reinforcing attractions for all age groups to create a 'buzz' of activity and greater security throughout the year. Integration of sports, play and leisure.

- i More play facilities of all kinds for all age groups throughout the area.
- ii Picnic areas and seating overlooking sports and play.
- iii Events programme, especially during school holidays for children, but also for other age groups.
- iv More events on the Oval - markets, festivals, shows and tournaments.
- v An inspiring adventurous playground.
- vi Indoor children's facilities including daycare, nursery, 1 o'clock club, creche, after school club.
- vii All year café overlooking facilities.
- viii Public art, sculpture and trails throughout the area.
- ix Imaginative new attractions such as mazes and water features.
- x Earth banked amphitheatre with seating on the Oval. (Football pitch to move slightly southwards.)
(your ideas).....

agree
disagree
no opinion

2. High quality, sustainable environment

Quality building and landscape on the West side of the Gardens to match, if not exceed, that on the East.

- i More planting including special garden areas (eg wildflower garden, winter garden, 'secret' garden, pergolas, conservatory).
- ii Imaginative lighting scheme to make it an atmospheric and safe area to walk through at night. Use of floodlit features, solar lighting, movement activated lights and light shows for special events.
- iii Resurface paths in sealed gravel with special paved feature areas.
- iv Restore curved steps and other historic features.
- v Rigorous, sustainable design standards for all new buildings.
- vi Viewing tower or raised mound at the highest point to make more of the spectacular views.
- vii Use of solar and wind power (both for energy saving and as a feature).
(your ideas).....

agree
disagree
no opinion

3. Centre of sporting excellence

Improve existing facilities and introduce new ones to make the Gardens - together with nearby facilities - a centre of sporting excellence.

- i Upgrade skate park/BMX facilities to competition standard - larger area, lighting, learner skatepark, features for street skating and separate BMX area.
- ii Upgrade tennis courts with new nets, windbreak planting, lighting, resurfacing in colour, viewing areas.
- iii Reinstate basketball court as multipurpose court for basketball, kick around, rollerblading.
- iv Improve minigolf area with planting of trees and shrubs and low picket fencing to discourage people and dogs walking across the course.
- v Use banks for viewing sports and shelter planting to reduce wind impact.
- vi New sports pavilion and café with viewing terraces, changing rooms, toilets, showers, clubrooms for tennis and other activities, information office and first aid point. (Minigolf to have exclusive use of old pavilion once this is built.)
- vii Earth contoured BMX/MTB track/trail at north end of Oval.
(your ideas).....

agree
disagree
no opinion

4. Better access

More convenient and pleasurable access to the Gardens and better links within the Gardens.

- i System of signposting within the Gardens.
- ii New tree lined avenue around The Oval for walking, running and cycling.
- iii Marked cyclist routes and cycle parks.
- iv Improve entrance gateways with imaginative, welcoming new designs.
- v Paved crossings across Falaise Road.
- vi Investigate using 'head on' parking in Falaise Road to increase the number of parking spaces.
- vii Elegant bridge across Bohemia Road to the Museum for walking and cycling. Linking also to the Greenway to the station and town centre.
- viii Motorised transport system from the pier to Summerfields Leisure Centre with stops at key points in the Gardens: Possibilities include outdoor escalator, cable car, funicular railway. Possible extension to Hastings station.
- ix Access route to Magdalen Road providing more direct access to St Leonards Station. Subject to negotiation with owners of the site to the East.

(your ideas).....

Objectives and proposals (please tick boxes and add suggestions)

agree
disagree
no opinion

5. A Big Draw

Something regionally or even nationally special to attract locals and visitors to the Gardens. A feasibility study or competition is needed to decide what. Possibilities include some or all of the following:

- i Massive helter skelter.
- ii Low key roller coaster making use of the natural slope.
- iii Spectacular transport system (eg cable car - see section 4)
- iv Tropical plant house (see 6 below).
- v Wind turbine with viewing gallery.
- vi Dry ski slope.

(your ideas).....

.....

.....

agree
disagree
no opinion

6. New landmark building

Incorporate all new indoor facilities required - including the already committed new indoor bowls centre - in a single new multipurpose building of landmark quality. Feasibility study or competition needed to explore options? Possibilities include some or all of the following:

- i Indoor bowls.
- ii Indoor tennis.
- iii Conservatory for special plants.
- iv Roof terrace.
- v Viewing galleries for all facilities.
- vi Restaurant.
- vii Function facilities.
- viii Information office.
- ix Underground car parking.

(your ideas).....

.....

.....

agree
disagree
no opinion

7. Promotion

Comprehensive marketing and promotion of the area as a whole and the individual facilities within it.

- i Establish clear promotional identity for the area - including East and West sides of the Gardens, the Museum, Summerfields and perhaps Horntyte.
- ii Layout map of Gardens and Information Boards displayed at all entrances with details of facilities available.
- iii Signposting from the seafront and from Hastings and St Leonards town centres (pedestrian, cycle and vehicle routes).
- iv Produce a Gardens Guide brochure.

(your ideas).....

.....

.....

agree
disagree
no opinion

8. Public involvement

Ongoing involvement of Garden users, facility operators and the general public in the management and development of the area.

- i Start 'Friends of White Rock Gardens' group.
- ii Form Steering Group of main interest groups.
- iii Support Special interest groups (eg BMX/skaters, mini golfers, tennis players, bowlers, etc).
- iv Newsletter (similar to that for Alexandra Park).
- v Information boards at entrance points and at main facilities with latest developments.
- vi Establish on site information and development office.

(your ideas).....

.....

.....

Send in your views

- 1 Tick the boxes and add any suggestions in the spaces provided (or draw or write on the plan).
- 2 Enter your name and contact details (optional).
- 3 Post to 'Freepost PTL' (no stamp required)

All named entries will be entered in a prize draw for a family ticket to a show of your choice from the current programme at White Rock Theatre.

General comments.....

.....

.....

Name.....

Address.....

.....

.....

Tel/email.....

For any queries regarding this consultation programme please contact: Martin Etchells, Leisure Manager, Hastings Borough Council, 4 Robertson Terrace, Hastings, East Sussex TN34 1JE. Tel: 01424 781103 Email: metchells@hastings.gov.uk

Further copies of this Draft Masterplan can be obtained from Hastings Information Centre, Queens Square, Priory Meadow, Hastings, East Sussex TN34 1TL Tel: 01424 781111 Email: hic_info@hastings.gov.uk A full report on the results of the first phase of consultation can also be inspected there.

Draft masterplan by means of public consultation produced under contract for Hastings Borough Council by Nick Wates Associates. Landscape architect: Alexandra Rook. Graphic design: Tim Cross. Illustration: Peter Smith. May 2002. Many thanks to all those who have already given up their time to assist with this consultation programme.