

White Rock Gardens Masterplan

Background Report on second phase of Public Consultation in July 2002



For any queries regarding this consultation programme please contact:
Martin Etchells, Leisure Manager, Hastings Borough Council,
4 Robertson Terrace, Hastings, East Sussex, TN34 1JE.
Tel: 01424 781103 Email: metchells@hastings.gov.uk

Produced under contract for Hastings Borough Council by Nick Wates in association with
Alexandra Rook, Civic Trust Regeneration Unit.

August 2002

1	Introduction and conclusions	3
1.1	About this report	3
1.2	The consultation process	3
1.3	The consultation response	4
1.4	Consultation findings summary	4
1.5	Way forward	5
2	Consultation Findings	6
2.1	Range of attractions for all	6
2.2	High quality, sustainable environment	8
2.3	Centre of sporting excellence	9
2.4	Better access	10
2.5	A big draw	12
2.6	New landmark building	13
2.7	Promotion	15
2.8	Public involvement	16
2.9	General comments	16
2.10	Endorsements	18
APPENDIX		
	Draft Masterplan as published in <i>About</i> magazine	20

1 Introduction and conclusions

1.1 ABOUT THIS REPORT

- 1.1.1 This background report sets out the results of the second phase of public consultation on White Rock Gardens which took place in July 2002. It should be read in conjunction with the Masterplan 2002, submitted to Hastings Borough Council by the consultants for formal consideration.
- 1.1.2 The Masterplan is based on the results of two phases of public consultation. The consultants have incorporated as many of the ideas put forward as possible in a programme of short, medium and long term improvements.

1.2 THE CONSULTATION PROCESS

- 1.2.1 The first phase of public consultation took place in February 2002 and involved over 200 people taking part in two Community Design Days and 116 people submitting written or drawn suggestions in response to a consultation flyer. The results are contained in a separate report entitled 'Background Report on first phase of Public Consultation, February 2002'.
- 1.2.2 This was used as a basis for drawing up a Draft Masterplan. The second phase of public consultation took place in July 2002 and involved seeking comments on the Draft Masterplan. The plan was published as a pull-out feature in the summer issue of the Council's *About* Magazine which is distributed to all households in the Borough. The feature was in the form of a reply-paid questionnaire and contained a listing of the objectives and proposals (see Appendix). People were asked to use tick boxes to indicate whether they agreed, disagreed or had no opinion on each of the proposals and space was provided for making additional comments on each objective and on the plan as a whole.
- 1.2.3 A letter was sent out to all those who had taken part in the first round of public consultation drawing attention to the feature in *About* magazine. A press release was also issued to remind people to respond.

1.3 THE CONSULTATION RESPONSE

- 1.3.1 A total of 110 completed questionnaires were returned.
- 1.3.2 No personal details were requested from respondents but it would appear from the comments that all the existing sporting and other main interest groups using the Gardens were well represented. Responses were also received from a range of age groups and from people in different parts of the Borough.
- 1.3.3 It is clear from the returned questionnaires that people have generally understood the proposals and have reacted thoughtfully to them. Only a handful of forms display evidence of people championing one particular cause. Only a handful of people declined to complete their names and addresses.
- 1.3.4 It is therefore considered that the response can be treated as reasonably representative of the views of the current users of the Gardens and residents of the Borough in general.

1.4 CONSULTATION FINDINGS SUMMARY

- 1.4.1 There is a good measure of agreement on the eight objectives proposed, subject only to a general feeling that the big draw should not be too big or too commercial and that the landmark building should also not be too large.
- 1.4.2 There is a good measure of agreement on all of the proposals put forward apart from the helter skelter and roller coaster suggestions for a big draw. The preference was for a draw involving water, plants or sports. The Masterplan has been changed accordingly.
- 1.4.3 There is concern by some about the proposals to site facilities at the north side of the Oval (BMX/MTB track/trail and Amphitheatre). Alternative possible locations for each of these facilities are therefore suggested for consideration at feasibility stage.
- 1.4.4 A large number of useful comments and suggestions have been made and it has been possible to revise the Masterplan to incorporate most of them. It would however be worth reviewing them again at feasibility stage. It would also be worth reviewing the detailed suggestions made during the first phase of consultation at the same time.
- 1.4.5 The general response to the Draft Masterplan has been extremely enthusiastic as can be seen from the quotes set out in para 2.10 as well as the high level of support for the individual proposals.

1.5 WAY FORWARD

- 1.5.1 The revised Masterplan would appear to provide a sound basis on which to proceed.
- 1.5.2 Following formal approval by Hastings Borough Council, detailed feasibility and design work will be needed to firm up specific proposals and make choices between the options presented.
- 1.5.3 The Covenants on the land need to be checked by the Borough Solicitor to ensure that the proposals do not conflict with them.
- 1.5.4 The Masterplan could perhaps form the centrespread of a newsletter on White Rock Gardens updating people on progress.
- 1.5.5 The Masterplan should perhaps be revised and updated annually as feasibility and design work proceeds.

2. Consultation analysis

The questionnaire comprised the proposals listed under 8 objectives (see Appendix). Tick boxes were provided for both objective s and the activities proposed to achieve them. In practice most people only completed the latter.

This section contains the text of the questionnaire with analysis of the votes cast. Additional ideas and comments for each objective are summarised after the analysis. General comments are then summarised with endorsements recorded as direct quotes at the end.

2.1 Range of attractions for all

	<i>Objective</i>	<i>Agree</i>	<i>Disagree</i>	<i>No opinion</i>
1	Range of attractions for all. A greater range of diverse, mutually reinforcing attractions for all age groups to create a ‘buzz’ of activity and greater security throughout the year. Integration of sports, play and leisure.	25 (96%)	0	1 (4%)

	<i>Actions</i>	<i>Agree</i>	<i>Disagree</i>	<i>No opinion</i>
i	More play facilities of all kinds for all age groups throughout the area.	79 (75%)	13 (12%)	14 (13%)
ii	Picnic areas and seating overlooking sports and play.	88 (83%)	8 (7%)	11 (10%)
iii	Events programme, especially during school holidays for children, but also for other age groups.	86 (81%)	5 (5%)	15 (14%)
iv	More events on the Oval - markets, festivals, shows and tournaments.	89 (86%)	5 (5%)	9 (9%)
v	An inspiring adventurous playground.	70 (68%)	8 (8%)	25 (24%)
vi	Indoor children’s facilities including daycare, nursery, 1 o’clock club, creche, after school club.	63 (63%)	13 (13%)	24 (24%)
vii	All year cafe overlooking facilities.	92 (91%)	2 (2%)	7 (7%)
viii	Public art, sculpture and trails throughout the area.	62 (61%)	13 (13%)	26 (26%)
ix	Imaginative new attractions such as mazes and water features.	76 (75%)	14 (14%)	11 (11%)
x	Earth banked amphitheatre with seating on the Oval. (Football pitch to move slightly southwards.)	58 (55%)	17 (16%)	30 (29%)

Additional ideas and comments

- a) Concern over possible noise and nuisance problems from events on the Oval eg Rock concerts.
- b) No amplified music or speech.
- c) Smooth rise of paths entering Oval for wheelchairs.
- d) Outdoor swimming pool.
- e) Water garden with fish.
- f) Amphitheatre should be more robust – concrete or slabs.
- g) Regular weekend and evening events with places to eat.
- h) Cafe should be short term not medium term.
- i) Top part of Oval needs tidying up.
- j) New sports stadium on Oval – easier to get to than Pilot Field and Parker running tracks.
- k) More parking needed if more events on Oval planned.
- l) Public art and new attractions better in Alexandra Park.
- m) Water maze like at Hever Castle (2).
- n) Mini play area for small children and babies.
- o) Play area like one in Folkstone.
- p) Interactive water features for all ages.
- q) Recycled materials for play facilities.
- r) More collections from litter bins.
- s) Seating so families can watch children.
- t) More seating for disabled.
- u) Music and Green festivals on the Oval.
- v) Miniature railway.
- w) Trampolines.
- x) Slightly raised fragrant flower beds for wheelchair users and the blind.
- y) Site specific art installations like at Marina.
- z) Adventurous playground should be short term rather than medium term.
- aa) Warden/security system needed to protect young children and new facilities.
- bb) Amphitheatre already made in Linton Gardens and originally used as such.
- cc) A meeting place for teenagers.
- dd) Include amphitheatre in viewpoint – leave north part of Oval as natural woodland buffer.
- ee) Novelty timepiece like the famous Guinness clock in Battersea Park – with a maritime or 1066 theme.
- ff) More boot fairs on the Oval (2).
- gg) Pets corner.
- hh) Themed garden as at Newhaven.
- ii) More for 12-18 year olds – will reduce crime.
- jj) Involve youngsters through art/public/sculpture workshops, then have performances in the amphitheatre.
- kk) Playground to be as natural as possible (trees, logs etc).
- ll) Concentrate on one or two attractions. More indoor facilities for all year round.

2.2 High quality, sustainable environment

	<i>Objective</i>	<i>Agree</i>	<i>Disagree</i>	<i>No opinion</i>
2	High quality, sustainable environment. Quality building and landscape on the West side of the Gardens to match, if not exceed, that on the East.	26 (100%)	0	0

	<i>Actions</i>	<i>Agree</i>	<i>Disagree</i>	<i>No opinion</i>
i	More planting including special garden areas (eg wildflower garden, winter garden, 'secret' garden, pergolas, conservatory).	88 (84%)	5 (5%)	12 (11%)
ii	Imaginative lighting scheme to make it an atmospheric and safe area to walk through at night. Use of floodlit features, solar lighting, movement activated lights and light shows for special events.	93 (90%)	7 (7%)	3 (3%)
iii	Resurface paths in sealed gravel with special paved feature areas.	75 (73%)	10 (10%)	18 (17%)
iv	Restore curved steps and other historic features.	86 (84%)	7 (7%)	9 (9%)
v	Rigorous, sustainable design standards for all new buildings.	83 (79%)	2 (2%)	20 (19%)
vi	Viewing tower or raised mound at the highest point to make more of the spectacular views.	77 (74%)	9 (9%)	17 (17%)
vii	Use of solar and wind power (both for energy saving and as a feature).	77 (74%)	7 (7%)	20 (19%)

Additional ideas and comments

- a) Adequate policing and warden in constant attendance.
- b) Particularly keen on wildflower/conservation area.
- c) Tower could have solar panels and wind turbine and cafe.
- d) Solar power to be built in to south facing roofs and be unobtrusive.
- e) Wind turbine must not be noisy or an eyesore.
- f) Pedestrian underpass of Falaise Road would enhance environment of all the Gardens.
- g) Particularly keen on solar and wind power.
- h) Illuminated gardens for the summertime with pub garden.
- i) Wheel chair access to all facilities.
- j) Lighting must be more spectacular than at Marina and St Mary in the Castle (2).
- k) Solar not wind power.
- l) Water gardens – trickling water using slopes.
- m) Sensory Garden, Garden of Peace, place to sit in quiet, garden for the disabled.
- n) Recycling facilities.
- o) Gardens to be organic.

- p) Dog bins and litter bins.
- q) Remove fence on East side of Falaise Road, north section.
- r) Dogs only area with dogs not allowed in other parts (3).
- s) Ramps around all steps for disabled.
- t) Quiet areas as well as active areas.
- u) Gardens to be ambitious showing off talents of HBC grounds staff.
- v) Parts of Garden sponsored by local firms, like roundabouts are 'adopted' in Bournemouth.
- w) Take into account any animals living in the area and their living habitats.
- x) More seating (2).
- y) Early morning clean up operation.
- z) Live bands playing for charity.
- aa) Resurfacing paths a waste of money.
- bb) Scented garden.

2.3 Centre of sporting excellence

	<i>Objective</i>	<i>Agree</i>	<i>Disagree</i>	<i>No opinion</i>
3	Centre of sporting excellence. Improve existing facilities and introduce new ones to make the Gardens - together with nearby facilities - a centre of sporting excellence.	21 (84%)	2 (8%)	2 (8%)

i	Upgrade skate park/BMX facilities to competition standard - larger area, lighting, learner skatepark, features for street skating and separate BMX area.	73 (71%)	14 (14%)	16 (15%)
ii	Upgrade tennis courts with new nets, windbreak planting, lighting, resurfacing in colour, viewing areas.	80 (74%)	16 (15%)	12 (11%)
iii	Reinstate basketball court as multipurpose court for basketball, kick around, rollerblading.	76 (75%)	9 (9%)	17 (16%)
iv	Improve minigolf area with planting of trees and shrubs and low picket fencing to discourage people and dogs walking across the course.	78 (75%)	10 (10%)	16 (15%)
v	Use banks for viewing sports and shelter planting to reduce wind impact.	95 (90%)	1 (1%)	10 (9%)
vi	New sports pavilion and cafe with viewing terraces, changing rooms, toilets, showers, clubrooms for tennis and other activities, information office and first aid point. (Minigolf to have exclusive use of old pavilion once this is built.)	88 (88%)	6 (6%)	6 (6%)
vii	Earth contoured BMX/MTB track/trail at north end of Oval.	53 (52%)	19 (19%)	27 (27%)

Additional ideas and comments

- a) Two new buildings not necessary.
- b) Ask Stuart at Backyard for his opinion on earth contoured BMX track.
- c) Sports pavilion should be short term not medium term.
- d) Put mini golf and crazy golf on same site.
- e) At least one covered tennis court needed. Nearest one is at Windmill Hill.
- f) No room on plan for a dry ski slope using natural slope.
- g) Terrace the banks rather than have separate BMX/MTB track (re vii).
- h) Budget for maintenance – otherwise no point in these ideas.
- i) Not enough free activities.
- j) Ambulance parking space needed.
- k) Improvements must be done in consultation with current users of facilities.
- l) Skatepark to merge into scheme rather than sticking out like a sore thumb.
- m) Move earth contoured BMX/MTB track to skatepark.
- n) Decide criteria – not enough room for sporting excellence and other activities.
- o) Award winning toilets – the best on the south coast.
- p) Speak to youth clubs and schools to find out what facilities children want.
- q) Install boules pitches.
- r) Tennis courts to be multi-use to include soccer-tennis for instance.
- s) Events such as Backyard Jam, Skateboarding events (without prohibitive costs for youngsters).
- t) Upgrade Falaise Hall area with information area and first aid. Extend cafe opening hours.
- u) Cafe to sell healthy and vegetarian foods – not just greasy spoon.
- v) Control of cycling where it is not permitted.

2.4 Better access

	<i>Objective</i>	<i>Agree</i>	<i>Disagree</i>	<i>No opinion</i>
4	Better access More convenient and pleasurable access to the Gardens and better links within the Gardens.	21 (78%)	5 (19%)	1 (3%)

	<i>Action</i>	<i>Agree</i>	<i>Disagree</i>	<i>No opinion</i>
i	System of signposting within the Gardens.	78 (77%)	5 (5%)	18 (18%)
ii	New tree lined avenue around The Oval for walking, running and cycling.	81 (80%)	11 (10%)	10 (10%)
iii	Marked cyclerroutes and cycle parks.	70 (69%)	18 (18%)	13 (13%)
iv	Improve entrance gateways with imaginative, welcoming new designs.	75 (73%)	13 (13%)	15 (14%)
v	Paved crossings across Falaise Road.	73 (73%)	10 (10%)	17 (17%)

vi	Investigate using head-on parking in Falaise Road to increase the number of parking spaces.	79 (77%)	10 (10%)	14 (13%)
vii	Elegant bridge across Bohemia Road to the Museum for walking and cycling. Linking also to the Greenway to the station and town centre.	79 (76%)	15 (14%)	10 (10%)
viii	Motorised transport system from the pier to Summerfields Leisure Centre with stops at key points in the Gardens: Possibilities include outdoor escalator, cable car, funicular railway. Possible extension to Hastings station.	76 (72%)	19 (18%)	10 (10%)
ix	Access route to Magdalen Road providing more direct access to St Leonards Station. Subject to negotiation with owners of the site to the East.	62 (59%)	17 (16%)	26 (25%)

Additional ideas and comments

- a) Modern tram system linking all the town's main attractions.
- b) Raised walkway or bridge over Falaise Road rather than a crossing.
- c) Re vii. Multi-use tickets – 1 ticket for any facility at any time – per day.
- d) Create single lane flyover link from Falaise Road to seafront.
- e) Particularly keen on funicular railway.
- f) Long term goal to purchase ground from convent as additional green space.
- g) Signposting to St Thomas of Canterbury Church (see i & ix)
- h) More use could be made of the St Margaret Road carpark.
- i) Town needs park and ride.
- j) Is there enough space for a funicular railway?
- k) Minibuses could be used to ferry people up the hill.
- l) More visible and inviting entrance from St Margaret's Road (re iv).
- m) Tramway from Ore, Hollington etc to town park and ride.
- n) Include disabled parking (re vi).
- o) Additional free parking to encourage visitors (2).
- p) Convenient and cheap parking (3).
- q) Improve Falaise Road car park edge to improve view.
- r) Relocate car park entrance to avoid conflict with proposed crossing.
- s) Disabled access for all facilities (5).
- t) All access to be very visible – no dark, hidden paths or corners.
- u) Dotto train like in Eastbourne.
- v) Bridge over Bohemia Road likely to be inappropriate and not aesthetically pleasing.
- w) Concern about encouraging cyclists into the Gardens – can take away the unique character.
- x) CCTV for safer parking.
- y) Lift from bottom of steps at White Rock Road to footbridge over Clambers.
- z) Long term ideas to be funded from SRB and done immediately.

2.5 A Big Draw

	<i>Objective</i>	<i>Agree</i>	<i>Disagree</i>	<i>No opinion</i>
5	A Big Draw Something regionally or even nationally special to attract locals and visitors to the Gardens. A feasibility study or competition is needed to decide what. Possibilities include some or all of the following:	18 (69%)	5 (19%)	3 (12%)

	<i>Action</i>	<i>Agree</i>	<i>Disagree</i>	<i>No opinion</i>
i	Massive helter skelter.	12 (12%)	71 (73%)	14 (15%)
ii	Low key roller coaster making use of the natural slope.	17 (18%)	61 (64%)	17 (18%)
iii	Spectacular transport system (eg cable car – see section 4)	58 (59%)	25 (25%)	16 (16%)
iv	Tropical plant house (see 6 below).	61 (62%)	19 (20%)	18 (18%)
v	Wind turbine with viewing gallery.	41 (42%)	30 (30%)	28 (28%)
vi	Dry ski slope.	50 (51%)	31 (31%)	18 (18%)

Additional ideas and comments

- a) Ice skating rink big enough for national events (2).
- b) Tropical plant house better in Alexandra Park (3).
- c) Need a fun pool somewhere in the town.
- d) Ski slope better on East Hill.
- e) Skylon (as at Niagara).
- f) Ferris wheel (like London Eye) (2).
- g) Roller coaster could be out of keeping with covenanted usage.
- h) Beautiful mythical Fairy Garden similar to old Model Village.
- i) The view tower could incorporate wind turbine and cafe.
- j) Maze like the one at Leeds Castle.
- k) Fairground not in keeping but good to see helter skelter elsewhere.
- l) Particularly keen on funicular railway.
- m) Walk-through aviary like Snowdon aviary at London zoo.
- n) Concerts.
- o) Outdoor sculptures and other forms of visual art.
- p) Are the transport links sufficient for a big draw?
- q) Spectacular interactive water gardens with touch sensitive displays, walk-through water tunnels incorporated with tropical plant house.
- r) Could an environmentally friendly roller coaster, blending in with plants, be designed.

- s) Interactive water feature as at Picadilly Gardens, Manchester and St Helier promenade, Jersey - both a huge success.
- t) Outdoor swimming pool that could be frozen in winter for ice-skating.
- u) Aqua/water park.
- v) Mini Eden project.
- w) Revolving restaurant and viewing gallery for top class events, eg weddings.
- x) Not anything loud and noisy.
- y) No room for dry ski slope.
- z) Other areas would benefit from this eg Alexandra Park. Don't overlap White Rock.
- aa) Spectacular clock with moving maritime figures on the hour – visible from the seafront promenade.
- bb) Toboggan run.
- cc) Waterslide – log and flume type run.
- dd) Keep the relaxed atmosphere of WRG, not everywhere has to be a spectacular entertainment centre.
- ee) Nearest dry ski slope is in Bromley on A20. This idea would be good draw for all ages and abilities.
- ff) Should not be like a fairground – mazes etc preferred.
- gg) The wrong site for anything major. People attend these gardens for the peace and quiet.

2.6 New landmark building

	<i>Objective</i>	<i>Agree</i>	<i>Disagree</i>	<i>No opinion</i>
6	New landmark building Incorporate all new indoor facilities required - including the already committed new indoor bowls centre - in a single new multipurpose building of landmark quality. Feasibility study or competition needed to explore options? Possibilities include some or all of the following:	18 (75%)	5 (21%)	1 (4%)

	<i>Action</i>	<i>Agree</i>	<i>Disagree</i>	<i>No opinion</i>
i	Indoor bowls.	69 (73%)	11 (11%)	15 (16%)
ii	Indoor tennis.	64 (66%)	16 (17%)	16 (17%)
iii	Conservatory for special plants.	69 (71%)	13 (14%)	15 (15%)
iv	Roof terrace.	78 (80%)	8 (8%)	11 (12%)
v	Viewing galleries for all facilities.	69 (76%)	6 (7%)	16 (17%)
vi	Restaurant.	82 (85%)	9 (9%)	6 (6%)

vii	Function facilities.	65 (68%)	10 (11%)	20 (21%)
viii	Information office	67 (71%)	10 (11%)	17 (18%)
ix	Underground car parking.	64 (67%)	13 (14%)	18 (19%)

Additional ideas and comments

- a) Indoor watersports facility with Olympic sized pool (4).
- b) Restaurant with panoramic views.
- c) A drop-in centre for learning first aid supported by the ambulance station.
- d) The bowls facility is most important – create a tournament venue for national matches.
- e) Should be of a size to attract televised national events.
- f) Underground car park must be vandal proof.
- g) All parking must be safe.
- h) Prefer more natural approach.
- i) Restaurant might clash with the cafe in the pavilion.
- j) Cafe not a restaurant.
- k) Indoor bowls available to all.
- l) Include slow moving walkway for the elderly and those using wheelchairs.
- m) Butterfly sanctuary.
- n) Youth club with activities.
- o) Ten pin bowling.
- p) Indoor leisure pool.
- q) Indoor skating rink.
- r) Pub.
- s) Include shower and changing facilities.
- t) Restaurant to cover vegetarian and vegan food.
- u) The future of Hastings lies in its past – don't spoil the Gardens.
- v) Disagree with landmark building – park should have diversity with numerous small scale focal points.
- w) Hard to get people to agree on design.
- x) What is needed is a high quality building but not a huge landmark.

3.7 Promotion

	<i>Objective</i>	<i>Agree</i>	<i>Disagree</i>	<i>No opinion</i>
7	Promotion Comprehensive marketing and promotion of the area as a whole and the individual facilities within it.	24 (92%)	2 (8%)	0

	<i>Action</i>	<i>Agree</i>	<i>Disagree</i>	<i>No opinion</i>
i	Establish clear promotional identity for the area - including East and West sides of the Gardens, the Museum, Summerfields and perhaps Horntye.	70 (70%)	8 (8%)	22 (22%)
ii	Layout map of Gardens and Information Boards displayed at all entrances with details of facilities available.	99 (96%)	1 (1%)	3 (3%)
iii	Signposting from the seafront and from Hastings and St Leonards town centres (pedestrian, cycle and vehicle routes).	87 (94%)	1 (1%)	5 (5%)
iv	Produce a Gardens Guide brochure.	75 (73%)	11 (11%)	17 (16%)

Additional ideas and comments

- a) No need for publicity if everything is done well (2).
- b) Information about Gardens in other parts of the town, eg shopping centre.
- c) Label plants and shrubs.
- d) Ask schools to design brochure.
- e) Signposting also from Old Town and West St Leonards.
- f) Annual magazine for all Hastings households.
- g) Include White Rock within promotional literature for Hastings – be inclusive.
- h) Content not spin please. Use the money for the content.

3.8 Public involvement

	<i>Objective</i>	<i>Agree</i>	<i>Disagree</i>	<i>No opinion</i>
8	Public involvement Ongoing involvement of Garden users, facility operators and the general public in the management and development of the area.	21 (91%)	0	2 (9%)

	<i>Action</i>	<i>Agree</i>	<i>Disagree</i>	<i>No opinion</i>
i	Start 'Friends of White Rock Gardens' group.	64 (62%)	13 (13%)	26 (25%)
ii	Form Steering Group of main interest groups.	54 (55%)	13 (13%)	31 (32%)
iii	Support Special interest groups (eg BMX/skaters, mini golfers, tennis players, bowlers, etc).	79 (77%)	9 (9%)	14 (14%)
iv	Newsletter (similar to that for Alexandra Park).	67 (68%)	9 (9%)	22 (23%)
v	Information boards at entrance points and at main facilities with latest developments.	86 (88%)	5 (5%)	7 (7%)
vi	Establish on site information and development office.	65 (66%)	11 (11%)	23 (23%)

Additional ideas and comments

- a) Involve all age groups from school children to the retired (2).
- b) Regular articles in local paper and on local TV
- c) Visit schools, colleges, workplaces.
- d) Too many committees tend to create closed shops.
- e) Information boards also in Braille.
- f) Integrate events and involvement with other things happening in Hastings.
- g) Volunteer scheme to keep up the gardens.
- h) Update reports in the Observer.

3.9 General comments

- a) Wonderful chance to promote health in the community and social activities.
- b) Need good business plan and expert advice.
- c) CCTV for all areas (2).
- d) We urgently need to improve the town's swimming facilities.
- e) Maximum publicity immediately for existing facilities.
- f) Must try not to outprice attractions for visitors.
- g) Excellent summer cafe in the Falaise Hall needs to be kept.

- h) Concern that too much notice taken of skateboarders views.
- i) Den for writers in the form of a cottage.
- j) Concern that an increase in popularity of the Gardens will lessen their peacefulness.
- k) Integrate improvements with impending local urban road improvements.
- l) Too busy. Keep all skateboarding/BMX activity in one place and make sure there is space for calm and tranquillity.
- m) The ideas for the Oval sound good as it is just a wasted space at the moment.
- n) Resurfacing the tennis courts, planting around them and floodlighting should be a priority.
- o) Budget for total security to prevent vandalism.
- p) Make Gardens attractive and usable for summer evenings.
- q) Information about parking and public transport in promotional material for visitors.
- r) Falaise Hall was a landmark building.
- s) Town desperately needs indoor waterpark.
- t) Commercial aspects should be brought forward to fund other aspects.
- u) Serious consideration to car parking needed (2).
- v) Long term is no good – it means things get shelved and not completed.
- w) Day to day maintenance is the most important thing.
- x) Avoid parking charges to achieve full use.
- y) Disabled access to all facilities.
- z) Clock in grounds somewhere.
- aa) Needs to be expert and good quality, not cheap and cheesy.
- bb) Raise the quality of appeal. Create a new sophisticated smarter image and don't compromise with out dated throwbacks to Hastings of old.
- cc) Too many requirements for a relatively small site – identify criteria. Possible use of land around Summerfields and Museum to increase site area.
- dd) White Rock needs to integrate within the overall development of Hastings via cycle/pedestrian routes etc.
- ee) Increase Summerfields carpark
- ff) Make footpath to station more secure.
- gg) Make gardens dog free.
- hh) Make use of the internet.
- ii) Make use of *Hastings Observer* – updates
- jj) Park security officers.
- kk) Acoustic barrier between Clambers/crazy golf and bowling greens.
- ll) Alarm system for bad behaviour or child attack.
- mm) Important that facilities stay free (eg skatepark) so those on low incomes don't miss out.
- nn) Upgrade area north of the Oval with reinstatement of water feature.
- oo) All facilities need to be vandal proof.
- pp) Big ideas are unsuited to the size of the site. Not too commercial please.
- qq) Please do not spoil the natural nature of the gardens with development.

3.10 Endorsements

Quotes from General Comments section

'Good luck for this project.'

'Excellent ideas.'

'I hope that such positive suggestions will be supported by the local authorities. I am too old (88) to take an active part.'

'Exciting proposals. Can't wait to see them implemented.'

'Very good ideas. Hope they come to fruition.'

'Very encouraging to see so much thought and interest in this wonderful asset.'

'I am pleased that so many of the public's comments have been incorporated in the Masterplan.'

'Please keep all residents up to date with the progress. Thank you.'

'It's a lovely area which is not used to the full because it's difficult to get to. I have only recently moved to Bexhill from St Leonards and still use the Gardens every week; Bexhill has nothing to compare with White Rock Gardens.'

'I fully agree with all the objectives and proposals. It would make White Rock Gardens a place to be proud of.'

'Your ideas are good on the whole – if it all takes place.'

'These are exciting proposals needing more cash than already promised - but hope springs.... etc.'

'Some of these ideas have great merit, some are surely the product of someone's hallucinatory imagination!'

'I think this is just what our town needs to make us a top tourist attraction. Excellent!'

'Just what is needed I think – an excellent plan for a 'special' area.'

'What a brilliant plan for the future of Hastings. Really exciting.'

'Very good ideas/plans seem to be coming together and hopefully will provide results soon.'

'A very imaginative scheme with very good and safe ideas.'

'Some very good ideas. We wish you success in carrying them out.'

'Good ideas.'

'Well put together proposal/consultation document.'

'Forget small interests like mini golf. Go for big things to beat Eastbourne, Bexhill and Seaford.'

'A great idea. Don't let it whither away – make something the town can be proud of.'

'Glad to see the Council planning something sensible.'

'Very far-sighted.'

'Be nice to see. Will help tourism and create jobs.'

'Some brilliant ideas to work on. Well done! Making an already lovely gardens even more practical and spectacular.'

'All good ideas.'

'Excellent ideas.'

'It all sounds great, but it will take far too long to benefit my family – up to 2011. Why does it all have to take so long?'

'A unique opportunity – wonderful!! Avoid 'glittery' lights, restaurants, style – emphasize the eco aspect (+ recreation).'

'Sounds very exciting but should not be dominated by sports and children.'

'Looks good.'

'It all sounds great!'

'Excellent ideas.'

'All ASAP'

'If any meeting happens about this, if possible contact me as I would like to be involved. Hastings definitely needs more for young people as I know it is rather boring.'

White Rock Gardens

DRAFT MASTERPLAN

Your views wanted

Improving White Rock Gardens

White Rock Gardens is the second largest park in Hastings and St Leonards and will be celebrating its centenary in 2004. Now there is an opportunity to improve this important area.

Hastings Borough Council has allocated £200,000 to improve the west side of the Gardens. In addition money has been set aside to replace the indoor bowling centre. With a new University planned for central Hastings, there may be other possibilities for attracting funding with the right ideas.

The Council is therefore preparing a Masterplan for the Gardens to ensure that the most is made of the opportunities and is keen to ensure that this reflects local views.

Building on success

The draft proposals in this document are based on feedback from over 200 people who attended two Community Design Days in February and 116 who submitted suggestions in writing or drawings.

Eight main objectives have been identified from this first round of public consultation, and over 50 detailed proposals for achieving them. These range from fairly simple improvements which could be implemented quite soon, to more visionary ideas which will need further investigation and fund raising.

The overall strategy is to build on and develop the many successful things already happening, at the same time as exploring a range of new initiatives designed to realise the tremendous potential of the area during the Gardens' second century.

What happens next?

Have we got it right? Is this what people want? Please:

- Read through this Draft Masterplan;
- Have another look round the Gardens and imagine what it might be like;
- Make your views known before the end of July.

The Masterplan will then be revised and considered formally by the Council as a basis for future action.



People taking part in the Community Design Days at White Rock Theatre on 22 & 23 February.

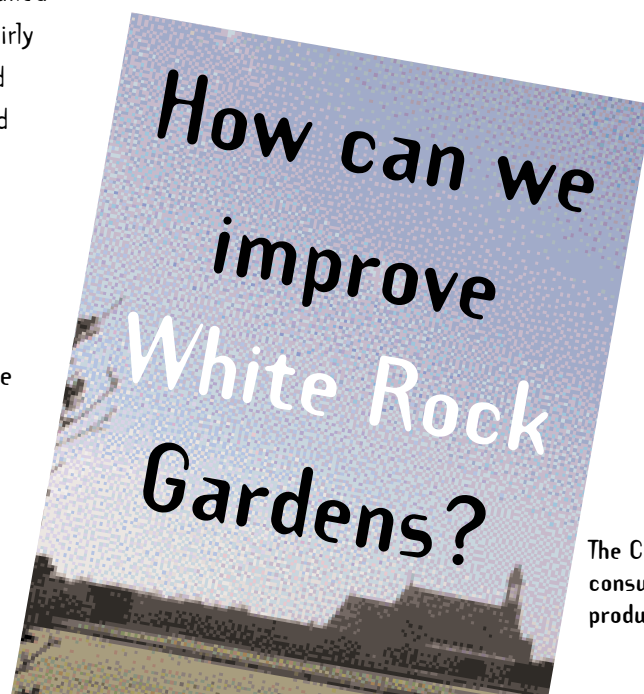

The Council's first consultation leaflet produced in February.

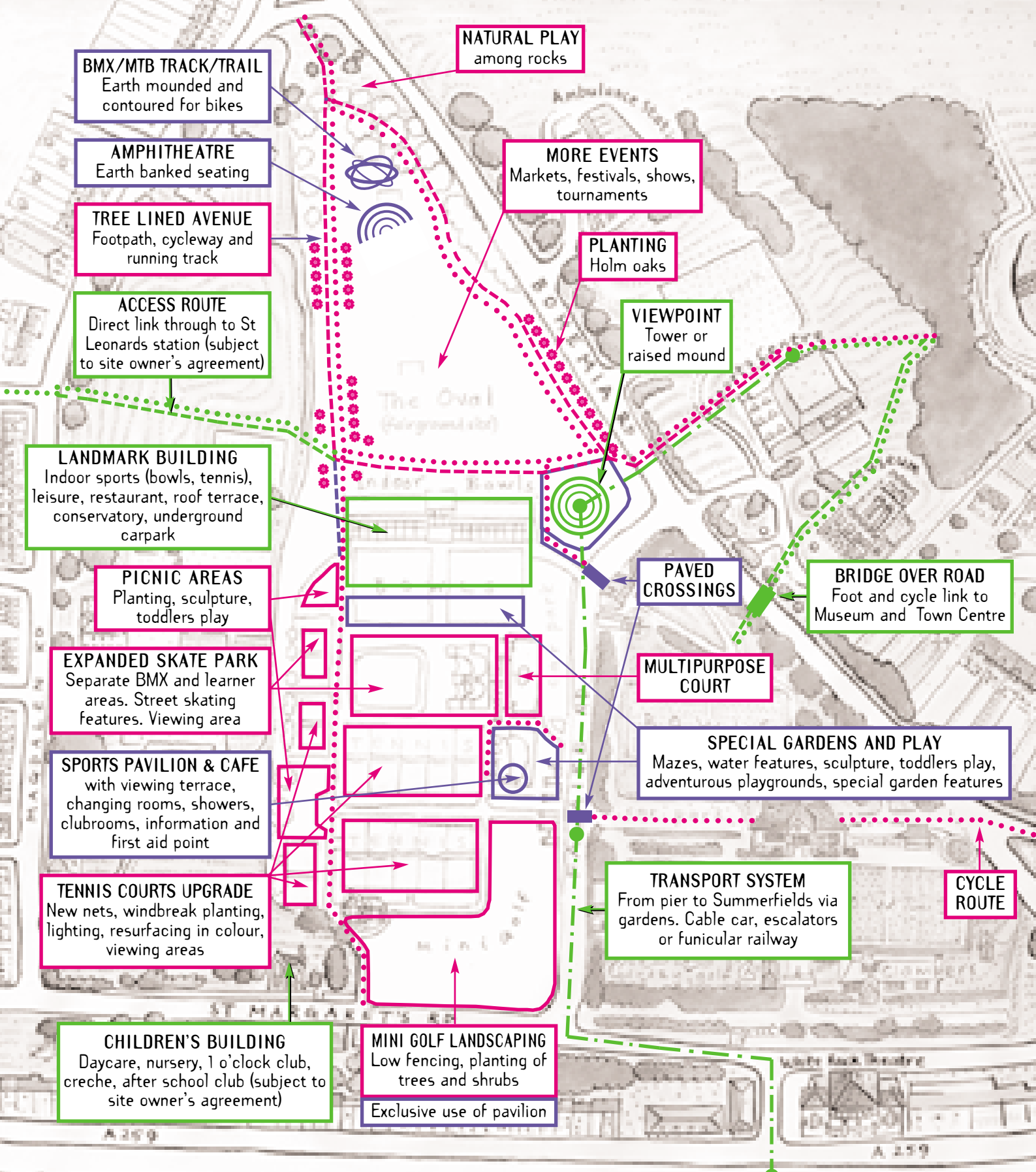

White Rock Gardens Draft Masterplan

MAIN NEW FEATURES

Short term
2003 - 2005



Medium term
2006 - 2010



Long term
2011 -



Objectives and proposals (please tick boxes and add suggestions)

agree
disagree
no opinion

1. Range of attractions for all

A greater range of diverse, mutually reinforcing attractions for all age groups to create a 'buzz' of activity and greater security throughout the year. Integration of sports, play and leisure.

- i More **play facilities** of all kinds for all age groups throughout the area.
- ii **Picnic areas and seating** overlooking sports and play.
- iii **Events programme**, especially during school holidays for children, but also for other age groups.
- iv More events on the Oval - **markets, festivals, shows and tournaments**.
- v An inspiring **adventurous playground**.
- vi **Indoor children's facilities** including daycare, nursery, 1 o'clock club, creche, after school club.
- vii All year **café** overlooking facilities.
- viii **Public art, sculpture and trails** throughout the area.
- ix Imaginative new attractions such as **mazes and water features**.
- x Earth banked **amphitheatre** with seating on the Oval. (Football pitch to move slightly southwards.)
(your ideas).....
.....
.....

agree
disagree
no opinion

2. High quality, sustainable environment

Quality building and landscape on the West side of the Gardens to match, if not exceed, that on the East.

- i More **planting** including **special garden areas** (eg wildflower garden, winter garden, 'secret' garden, pergolas, conservatory).
- ii Imaginative **lighting scheme** to make it an atmospheric and safe area to walk through at night. Use of floodlit features, solar lighting, movement activated lights and light shows for special events.
- iii **Resurface paths** in sealed gravel with **special paved feature areas**.
- iv **Restore** curved steps and other historic features.
- v **Rigorous, sustainable design standards** for all new buildings.
- vi **Viewing tower** or raised mound at the highest point to make more of the spectacular views.
- vii Use of **solar and wind power** (both for energy saving and as a feature).
(your ideas).....
.....
.....

agree
disagree
no opinion

3. Centre of sporting excellence

Improve existing facilities and introduce new ones to make the Gardens - together with nearby facilities - a centre of sporting excellence.

- i Upgrade **skate park/BMX facilities** to competition standard - larger area, lighting, learner skatepark, features for street skating and separate BMX area.
- ii Upgrade **tennis courts** with new nets, windbreak planting, lighting, resurfacing in colour, viewing areas.
- iii Reinstate basketball court as **multipurpose court** for basketball, kick around, rollerblading.
- iv Improve **minigolf area** with planting of trees and shrubs and low picket fencing to discourage people and dogs walking across the course.
- v Use banks for **viewing sports and shelter planting** to reduce wind impact.
- vi **New sports pavilion and café** with viewing terraces, changing rooms, toilets, showers, clubrooms for tennis and other activities, information office and first aid point. (Minigolf to have exclusive use of old pavilion once this is built.)
- vii **Earth contoured BMX/MTB track/trail** at north end of Oval.
(your ideas).....
.....
.....

agree
disagree
no opinion

4. Better access

More convenient and pleasurable access to the Gardens and better links within the Gardens.

- i System of **signposting** within the Gardens.
- ii New **tree lined avenue** around The Oval for walking, running and cycling.
- iii Marked **cycleroutes** and cycle parks.
- iv Improve **entrance gateways** with imaginative, welcoming new designs.
- v **Paved crossings** across Falaise Road.
- vi Investigate using **'head on' parking** in Falaise Road to increase the number of parking spaces.
- vii Elegant **bridge across Bohemia Road** to the Museum for walking and cycling. Linking also to the Greenway to the station and town centre.
- viii **Motorised transport system** from the pier to Summerfields Leisure Centre with stops at key points in the Gardens: Possibilities include outdoor escalator, cable car, funicular railway. Possible extension to Hastings station.
- ix **Access route to Magdalen Road** providing more direct access to St Leonards Station. Subject to negotiation with owners of the site to the East.
(your ideas).....
.....
.....

Objectives and proposals (please tick boxes and add suggestions)

agree
disagree
no opinion

5. A Big Draw

Something regionally or even nationally special to attract locals and visitors to the Gardens. A feasibility study or competition is needed to decide what. Possibilities include some or all of the following:

- i Massive helter skelter.
- ii Low key roller coaster making use of the natural slope.
- iii Spectacular transport system (eg cable car - see section 4)
- iv Tropical plant house (see 6 below).
- v Wind turbine with viewing gallery.
- vi Dry ski slope.

(your ideas).....

.....

.....

agree
disagree
no opinion

6. New landmark building

Incorporate all new indoor facilities required - including the already committed new indoor bowls centre - in a single new multipurpose building of landmark quality. Feasibility study or competition needed to explore options? Possibilities include some or all of the following:

- i Indoor bowls.
- ii Indoor tennis.
- iii Conservatory for special plants.
- iv Roof terrace.
- v Viewing galleries for all facilities.
- vi Restaurant.
- vii Function facilities.
- viii Information office.
- ix Underground car parking.

(your ideas).....

.....

.....

agree
disagree
no opinion

7. Promotion

Comprehensive marketing and promotion of the area as a whole and the individual facilities within it.

- i Establish clear promotional identity for the area - including East and West sides of the Gardens, the Museum, Summerfields and perhaps Horntyte.
- ii Layout map of Gardens and Information Boards displayed at all entrances with details of facilities available.
- iii Signposting from the seafront and from Hastings and St Leonards town centres (pedestrian, cycle and vehicle routes).
- iv Produce a Gardens Guide brochure.

(your ideas).....

.....

.....

agree
disagree
no opinion

8. Public involvement

Ongoing involvement of Garden users, facility operators and the general public in the management and development of the area.

- i Start 'Friends of White Rock Gardens' group.
- ii Form Steering Group of main interest groups.
- iii Support Special interest groups (eg BMX/skaters, mini golfers, tennis players, bowlers, etc).
- iv Newsletter (similar to that for Alexandra Park).
- v Information boards at entrance points and at main facilities with latest developments.
- vi Establish on site information and development office.

(your ideas).....

.....

.....

Send in your views

- 1 Tick the boxes and add any suggestions in the spaces provided (or draw or write on the plan).
- 2 Enter your name and contact details (optional).
- 3 Post to 'Freepost PTL' (no stamp required)

All named entries will be entered in a prize draw for a family ticket to a show of your choice from the current programme at White Rock Theatre.

General comments.....

.....

.....

Name.....

Address.....

.....

.....

Tel/email.....

For any queries regarding this consultation programme please contact: Martin Etchells, Leisure Manager, Hastings Borough Council, 4 Robertson Terrace, Hastings, East Sussex TN34 1JE. Tel: 01424 781103 Email: metchells@hastings.gov.uk

Further copies of this Draft Masterplan can be obtained from Hastings Information Centre, Queens Square, Priory Meadow, Hastings, East Sussex TN34 1TL Tel: 01424 781111 Email: hic_info@hastings.gov.uk A full report on the results of the first phase of consultation can also be inspected there.

Draft masterplan by means of public consultation produced under contract for Hastings Borough Council by Nick Wates Associates. Landscape architect: Alexandra Rook. Graphic design: Tim Cross. Illustration: Peter Smith. May 2002. Many thanks to all those who have already given up their time to assist with this consultation programme.